



Patiograss Datasheets

Patiograss Installation Instructions

Ref: PK200-4

Installing our Patiograss is easy if you follow these simple instructions. All you need are the right tools and a little care. If you are not certain about any step, call us before you start.

Have these tools ready

- Tape measure
- Stanley knife or similar
- Metal straight-edge
- Chalk and line or white pencil
- Notched trowel / spreader for adhesive
- Correct adhesive
- Seaming tape

How much do you need?

We offer our Patiograss in rolls 2 metres (approx. 6'6") or 4 metres (approx. 13') wide and in multiples of 1 metre lengths to suit your requirements. Check our product pages for the minimum size we supply for each carpet type. The maximum roll length of any roll is 30 metres. Carefully work out the lengths and widths you will require, to minimise wastage. For simple shaped areas it is relatively easy to work out your requirements. For more complicated areas it would be advisable to accurately draw a plan of the area to be covered.

In accordance with the Company's policy of continuous development, Boyd Sport & Play Ltd t/as sportsequip.co.uk reserve the right to alter or amend specifications without prior notice. All statements in this datasheet are made in good faith but the Company will not be held responsible for any consequence arising out of errors or omissions.

sportsequip.co.uk

The Manor, Tur Langton, Leicestershire, LE8 0PJ

t: 01858 545789 | f: 01858 545890 | e: info@sportsequip.co.uk

sportsequip.co.uk and Astroturf® are registered trademarks © sportsequip.co.uk 2013





Patiograss Datasheets

Patiograss Installation Instructions (cont'd)

Ref: PK200-4

What sort of base is required?

Patiograss may be laid on a wide variety of bases.

Hard (bound) surfaces - macadam, asphalt, concrete, etc.

All our Patio grasses may be laid directly onto any suitable hard sub surface.

If a new sub-surface is being constructed to take artificial grass a slight fall (1:200 is ideal) should be incorporated to assist drainage. Porous (open textured) macadam is particularly suitable as a sub base for all types of Patiograss.

Paving slabs are not suitable, because after a period of time the pattern of the slabs will show on the surface of the synthetic grass.

Unbound surfaces

Well compacted unbound aggregate (MOT 1 stone) bases are ideal for certain types of Patiograss - *PK201 Patiograss 14, PK202 Patiograss 15 and PK203 Patiograss 12*. If an artificial lawn were to be built from scratch, this type of base would be recommended. Any unbound surface, which drains and is stable and reasonably level however, is the perfectly satisfactory. If the surface is too rough it may be screeded with coarse sharp sand, prior to laying the grass.

In accordance with the Company's policy of continuous development, Boyd Sport & Play Ltd t/as sportsequip.co.uk reserve the right to alter or amend specifications without prior notice. All statements in this datasheet are made in good faith but the Company will not be held responsible for any consequence arising out of errors or omissions.

sportsequip.co.uk

The Manor, Tur Langton, Leicestershire, LE8 0PJ

t: 01858 545789 | f: 01858 545890 | e: info@sportsequip.co.uk

sportsequip.co.uk and Astroturf® are registered trademarks © sportsequip.co.uk 2013





Patiograss Datasheets

Patiograss Installation Instructions (cont'd)

Ref: PK200-4

Natural surfaces

Whilst our Patio grasses may be laid directly onto an existing lawn, provided the drainage is satisfactory in the long term. The natural grass will die off and the roots will decay, causing unevenness in the surface. Removal of the grass and compaction of the resulting soil base will overcome this problem, particularly if a screeding of course sand is installed.

Preparation

The smoothness of the finished job depends almost entirely on the preparation. Taking extra care and time here will pay dividends.

Get the base absolutely dry, clean and dust-free, levelling out any cracks, depressions or protrusions. Seal asphalted and raw timber surfaces after levelling. While you're doing all this, you should have your Patiograss rolled out in the sun somewhere clean and flat. That makes it more pliable and easier to handle.

In accordance with the Company's policy of continuous development, Boyd Sport & Play Ltd t/as sportsequip.co.uk reserve the right to alter or amend specifications without prior notice. All statements in this datasheet are made in good faith but the Company will not be held responsible for any consequence arising out of errors or omissions.

sportsequip.co.uk

The Manor, Tur Langton, Leicestershire, LE8 0PJ

t: 01858 545789 | f: 01858 545890 | e: info@sportsequip.co.uk

sportsequip.co.uk and Astroturf® are registered trademarks © sportsequip.co.uk 2013





Patiograss Datasheets

Patiograss Installation Instructions (cont'd)

Ref: PK200-4

Installing the Patiograss

First, decide the most convenient way to lay your Patiograss, across the area or along the length.

Joints are made by sticking the underside of the artificial grass to a special seaming tape by means of polyurethane adhesive. The edges to be joined are laid carefully together (*fig 1*) to ensure that everything fits as it should.

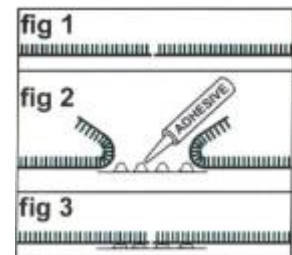

The edges are then folded back and the seaming tape laid, plastic side down, centrally along the joint (*fig 2*). Adhesive is applied from a cartridge gun to the top surface of the seaming tape, two "worms" of adhesive being applied to each side of the joint, one close to the point where the carpet will meet and the other about half way between the join and the edge of the tape.

The carpet is now folded back and pressed down to spread the adhesive (*fig 3*). The strength of the joint will be improved if the seam can be weighed down during the curing time of the adhesive.

Seaming tape and adhesive cartridges can be ordered when ordering the grass. Each cartridge of adhesive is sufficient for 3 metres of seam. For larger jobs, tins of adhesive are available. Please enquire or look at our web site www.sportsequip.co.uk

In accordance with the Company's policy of continuous development, Boyd Sport & Play Ltd t/as sportsequip.co.uk reserve the right to alter or amend specifications without prior notice. All statements in this datasheet are made in good faith but the Company will not be held responsible for any consequence arising out of errors or omissions.

sportsequip.co.uk

The Manor, Tur Langton, Leicestershire, LE8 0PJ

t: 01858 545789 | f: 01858 545890 | e: info@sportsequip.co.uk

sportsequip.co.uk and Astroturf® are registered trademarks © sportsequip.co.uk 2013





Patiograss Datasheets

Patiograss Installation Instructions (cont'd)

Ref: PK200-4

Securing the Patiograss

PK200 Patiograss 9, PK201 Patiograss 14 and PK204 Patiograss 7

For outdoor installations these surfaces should be adhered to a hard (bound) surface.

Always check which adhesive we recommend for the receiving surface you are adhering the Patiograss to. Where 2 pieces of Patiograss join, mark a line on the surface to be covered. Roll the Patiograss back about 75cm (2ft 6") and spread adhesive up to the line on either side. Place the Patiograss down along the line of adhesive ensuring the surface is positioned correctly along the pre-marked joint line. Use the back of a broom, a roller or hand pressure to press the Patiograss down and work out any air bubbles. Trim excess. On a dry moderate day, the adhesives dry in 8 hours and cure after 48 hours. Coverage rates vary dependant on the adhesive - please refer to the label instructions.

PK202 Patiograss 15

The weight of the infilling sand means that Patiograss 15 can be loose laid on any suitable base without further fixing.

PK203 Patiograss 1

If installed on the hard surface indoors or out, Patiograss 12 may be loose laid or spot stuck (see illustration). On an unbound surface it need only be secured at the edges.

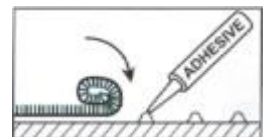

In accordance with the Company's policy of continuous development, Boyd Sport & Play Ltd t/as sportsequip.co.uk reserve the right to alter or amend specifications without prior notice. All statements in this datasheet are made in good faith but the Company will not be held responsible for any consequence arising out of errors or omissions.

sportsequip.co.uk

The Manor, Tur Langton, Leicestershire, LE8 0PJ

t: 01858 545789 | f: 01858 545890 | e: info@sportsequip.co.uk

sportsequip.co.uk and Astroturf® are registered trademarks © sportsequip.co.uk 2013





Patiograss Datasheets

Patiograss Installation Instructions (cont'd)

Ref: PK200-4

Edging Methods

1. By butting against an existing wall or upstanding kerb.
2. By fixing to an edge board - tanalised timber 100mm x 25mm located by wooden pegs 50mm x 50mm x 300mm is ideal.
3. By placing the edge of the Patiograss under paving stones or similar fence.
4. By burying the Patiograss edge under adjacent natural turf.

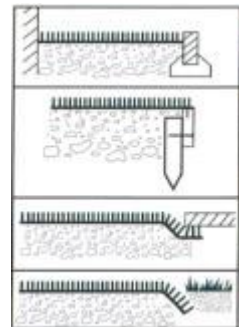

For indoor installations double-sided carpet tape can be used. Where 2 pieces of Patiograss join, mark a line on the surface to be covered. Turn back each piece of Patiograss and run double-sided carpet tape along each side of the line for the full distance. Place one side of the Patiograss down on the line, then butt the other piece to it and press down firmly on the tape. Do the same with the other joints, then tape all the outside edges. At this point it is easy to trim off any excess at the edges.

In accordance with the Company's policy of continuous development, Boyd Sport & Play Ltd t/as sportsequip.co.uk reserve the right to alter or amend specifications without prior notice. All statements in this datasheet are made in good faith but the Company will not be held responsible for any consequence arising out of errors or omissions.

sportsequip.co.uk

The Manor, Tur Langton, Leicestershire, LE8 0PJ

t: 01858 545789 | f: 01858 545890 | e: info@sportsequip.co.uk

sportsequip.co.uk and Astroturf® are registered trademarks © sportsequip.co.uk 2013





Patiograss Datasheets

Patiograss Installation Instructions (cont'd)

Ref: PK200-4

Patiograss Maintenance

Patiograss is a low maintenance surface. The rules are simple - remove debris, particularly leaves or pet droppings, since otherwise these will compost into the surface and allow moss to grow. Debris may be removed by sweeping and in dry conditions may be vacuumed with domestic appliance or a leaf buster. Do not vacuum sand filled Patiograss - the machine will fill with sand! If moss does form in the pile, it should be treated with a proprietary moss killer and swept thoroughly to remove the dead material. A bass broom or similar stiff brush is best for maintaining a 'fresh' appearance. Odd weeds that may seed themselves in the surface can be removed by hand or spot-sprayed with a general weed killer.

In accordance with the Company's policy of continuous development, Boyd Sport & Play Ltd t/as sportsequip.co.uk reserve the right to alter or amend specifications without prior notice. All statements in this datasheet are made in good faith but the Company will not be held responsible for any consequence arising out of errors or omissions.

sportsequip.co.uk

The Manor, Tur Langton, Leicestershire, LE8 0PJ

t: 01858 545789 | f: 01858 545890 | e: info@sportsequip.co.uk

sportsequip.co.uk and Astroturf® are registered trademarks © sportsequip.co.uk 2013

